

25AP Quick Connect “Has Quick Connect Fitting” Installation Instructions

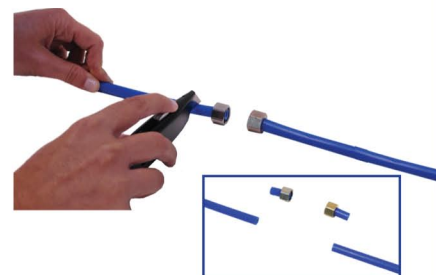

- 1 Locate and turn off the water supply to your NSA 25AP/25i.
- 2 Disconnect water lines from your NSA 25AP/25i.
- 3 Remove NSA 25AP/25i.

- 4 If you are replacing a 25AP or 25i with Compression Fittings (nut & bolts), simply use a razor knife and cut the nuts off of the water lines straight down. This will give you a square edge.



- 5 Measure and mark each water line 3/4" around tube.

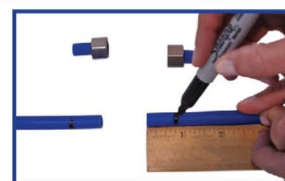

- 6 Take inlet line pushing the tube into the top fitting. Verifying you have inserted to the mark.

- 7 Flushing The Filter

Slowly turn on the water supply 1/2 way in order to flush the filter with lower volume and pressure. Please allow the filter to flush for 2 to 5 minutes into a bucket until the water runs clear.

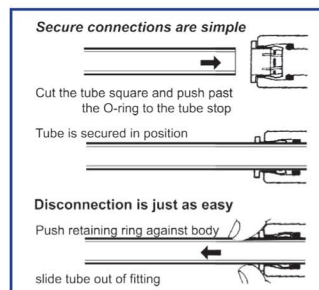

- 8 Connect the outlet line.

- 9 Turn on water supply to full pressure.

- 10 Check for leaks.

- 10a If water is leaking from a quick connect fitting:

- A) Turn off water supply and open faucet
- B) Disconnect water line from Quick Connect Fitting
- C) Using a razor knife trim the end of the water line making sure it is cut square, then insert into the fitting.

- 12 Please remember to mark the installation date and replacement date on the sticker provided.

WM Filter Replacement Reminder	
Model No.	_____
Installation Date	_____
Replacement Date	_____
(Estimated 3 yrs from Installation date)	